

How to use your robot. 如何使用机器人。

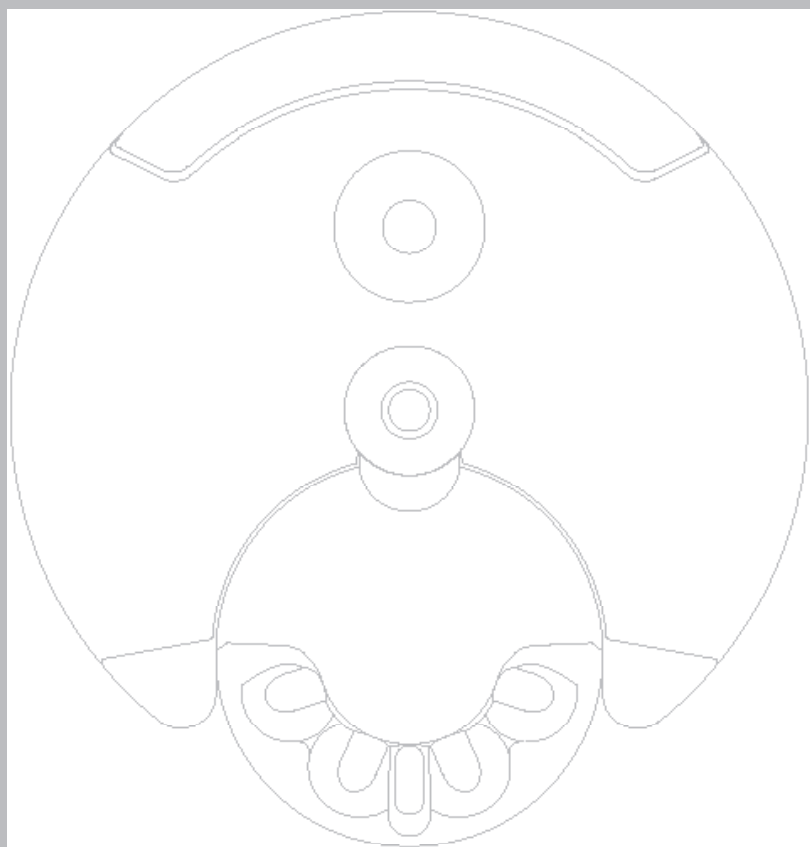

Thank you for choosing
to buy a Dyson robot
To read your manual
in English go to page 4.

感谢您选择购买戴森智能吸
尘机器人
如需阅读简体中文版手册，
请转至第 16 页。

Thank you for choosing to buy a Dyson robot

5
Download the Dyson Link app to get more from your robot

6
How your robot works

8
Starting a clean

10
Maintaining your robot's performance

14
Understanding your robot's lights

For further information and support:

Online: www.dyson.cn/supportcn

Email: china.service@dyson.com

On the phone: 4009 202 808

Download the Dyson Link app to get more from your robot

Personalise your robot.

Get step-by-step setup and support.

Control when your robot cleans.

Track your robot's cleaning progress.

Extend run time, increase suction or reduce noise by selecting from three different power levels.

Keep your robot up to date with automatic software upgrades.



Download the Dyson Link app from the App store or Android store.

Open the app and follow the on screen instructions to connect to your robot.



Apple and the Apple logo are trademarks of Apple Inc., registered in the U.S. and other countries. App Store is a service mark of Apple Inc., registered in the U.S. and other countries. Android and the Android logo are trademarks of Google LLC. The Android robot is reproduced or modified from work created and shared by Google and used according to terms described in the Creative Commons 3.0 Attribution License.

How your robot works

How to get the best cleaning performance.

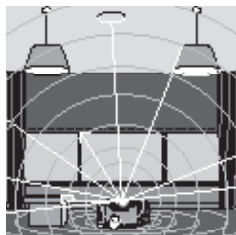

Navigation

A specifically designed vision system that guides your robot around your home.

Your robot views 360° around to fix its location in your home.

It also uses infra-red sensors to work out the size of your home and avoid obstacles such as furniture and stair drops.

Tip: The lens and infra-red sensors should be regularly cleaned using a dry, lint free cloth to help your robot see clearly.

Cleaning

Your robot uses a combination of patented Dyson technologies to keep your home clean.

Your robot uses a full width brush bar to clean to the edges of the room and a choice of power levels from the Dyson digital motor to clean all floor types.

Tip: To help your robot maintain its cleaning performance, regularly clean the filters and clear debris from the brush bar and tracks.

Personalisation

Use the Dyson Link app to personalise how and when your robot cleans.

Schedule your robot, telling it when to clean.

Choose between three power modes and adapt your robot to your home.

Tip: To make sure that your robot has full functionality, keep your app up to date to access new features and improvements as they are released.

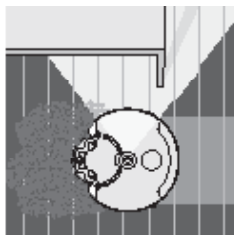

Illumination

LED lights help your robot clean in low light.

Your robot senses low light areas and uses its ring of LED lights to selectively illuminate those areas, helping it to navigate.

Tip: Keep the ring of LED lights clean by regularly cleaning with a soft, dry, lint free cloth.

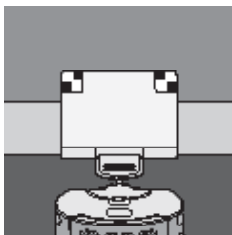

Runtime and Charging

The run times and charging times of your robot will always be approximate.

You do not have to wait for your robot to be fully charged before starting a clean.

Your robot will automatically recharge if started from the dock. During a clean, your robot will not fully recharge before resuming, to optimise the time spent cleaning.

Tip: See "Starting a clean" for more information about cleaning modes.

For further information and support:

Online: www.dyson.cn/supportcn

Email: china.service@dyson.com

On the phone: 4009 202 808

Starting a clean

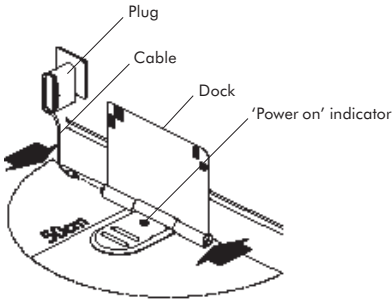

1

Setting Up

Open the dock fully to 90° and place it against the wall.

Plug the charging cable into either side of the dock.

Ensure the dock is powered, indicated by a blue light on the dock.

Tidy any surplus cable by wrapping it around the plug.

Ensure no objects are within approximately a 50cm radius of the dock.

2

Charging

Place your robot on the dock with the clear bin facing the wall.

The battery light will indicate that your robot is charging.

3

Preparing the room

Remove thin rugs or loose items that that your robot may suck up.

Tidy obstacles such as shoe laces or thin cables that may become entangled in the brush bar.

Clean any liquid spills or sharp items that may cause damage to your robot.

Ensure there are no items such as bags or shoes within 10cm of any drops in the room.

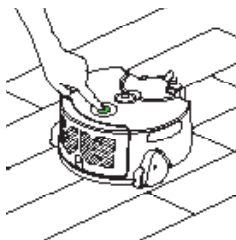
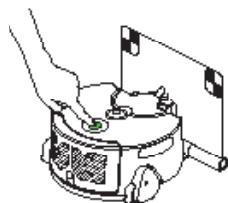

4

Automatic recharge

Press the button to clean all accessible areas.

Your robot will return to the dock to recharge when the battery is low.

Once recharged, your robot will automatically continue its clean.

Single charge

To clean a specific area, start your robot away from the dock.

Your robot will clean all the accessible space it can reach on a single charge.

Your robot will not recharge when the battery is low, but return to its starting point and switch 'OFF'.

TIP: The robot cannot be controlled via Dyson Link App when it is not on the dock, please manually start your robot.

For further information and support:

Online: www.dyson.cn/supportcn

Email: china.service@dyson.com

On the phone: 4009 202 808

Maintaining your robot's performance

Follow a few regular, simple maintenance steps.

Washing and drying the filters

Wash filters with cold water at least every month.

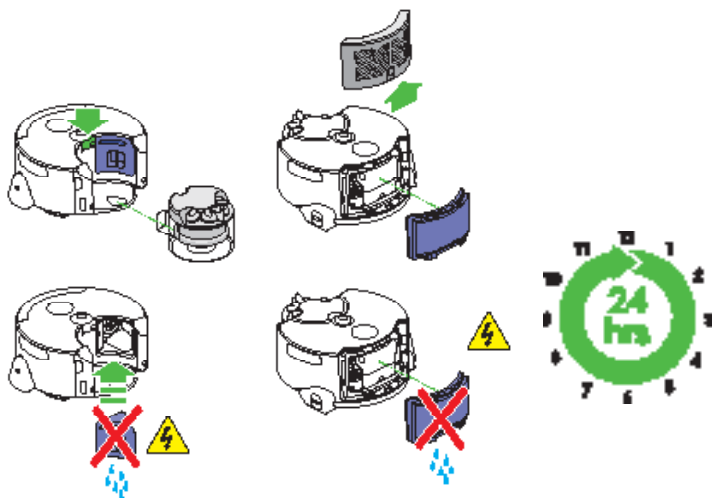

To remove the pre-motor filter:

Press the bin release button and remove the filter behind the bin.

To remove the post-motor filter:

Press the button of the filter cover and remove.

Pull the filter from the robot.

Wash the filters with cold water, repeat until the water runs clear.

Tap to remove excess water and leave to dry for at least 24 hours.

Ensure filters are completely dry before refitting.

To refit the pre-motor filter:

Push the filter back into position and refit the clear bin.

To refit the post-motor filter:

Push the filter back into position and refit the filter cover.

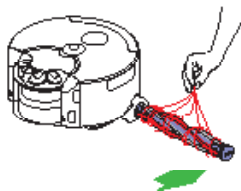

Brush bar maintenance

Check your brush bar regularly.

Detach the brush bar using a coin and remove any debris by hand.

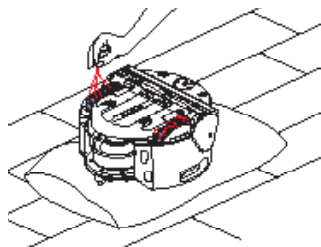

Track maintenance

Check your tracks regularly.

Place the robot upside down on a soft surface and remove any debris by hand.



Emptying the clear bin

Before every clean and when the dirt reaches the MAX mark. Press the bin release button. Place the whole bin in a bag, lift the cyclone out of the clear bin and empty the contents into the bag.



General cleaning

Check your infra-red sensors, lens and LED lights regularly.

Use a soft, dry, lint free cloth to wipe all over the robot and especially the infra-red sensors, lens and LED lights.

Maintaining your robot's performance

Continued.

Software upgrades

To get the best out of your robot, upgrade to the latest software.

Automatic upgrades via the Dyson Link app

By downloading the Dyson Link app you will be registered for automatic upgrades.

When an upgrade becomes available for your robot it will automatically download and install at the next available opportunity (when the robot is inactive, on the dock and connected to Wi-Fi).

Manually upgrade via USB

Check for software upgrades on the Dyson website, www.dyson.cn/supportcn and follow the step by step instructions.

For further information and support:

Online: www.dyson.cn/supportcn

Email: china.service@dyson.com

On the phone: 4009 202 808

Understanding your robot's lights

During a clean

Clean/Pause Button

Press the button to start a clean or pause your robot.
To power off, press and hold the button until the lights go out.

Battery level



Returning to dock

Your robot is returning to its dock to recharge.

Cleaning status ring

Indicates your robot's status.

Wi-Fi connection status

Get the Dyson Link app for more information.

Your robot needs your attention

Once you have finished looking after your robot, press the button to resume cleaning. Follow the instructions in "Maintaining your robot's performance".

Airways blocked

Check for blockages in your robot's airways. Clean your robot's filters.

Tracks or robot stuck

Check for debris wrapped around your robot's tracks. Recover your robot from any obstacle and place it nearby before cleaning.

Clean stopped

Your robot is unable to complete its clean. Return your robot to dock and start the clean as normal.

Brush bar stuck
Check for debris wrapped around your robot's brush bar.



Call Dyson Helpline

Your robot may need help from Dyson.



Software upgrade

Your robot is upgrading its software. Wait until the lights go out and start a clean as normal.

感谢您选择购买戴森智能吸尘机器人

17

下载 Dyson Link 应用程序以更好地利用您的智能吸尘机器人

18

智能吸尘机器人的工作原理

20

开始清洁

22

保持智能吸尘机器人的性能

26

了解智能吸尘机器人的指示灯

如需更多信息和支持:

在线方式: www.dyson.cn/supportcn

电子邮件: china.service@dyson.com

电话方式: 4009 202 808

下载 Dyson Link 应用程序以更好地利用您的智能吸尘机器人

个性化您的智能吸尘机器人。

获取分步骤设置指导和支持。

控制智能吸尘机器人在何时进行清洁。

跟踪智能吸尘机器人的清洁进度。

通过从三个不同的功率水平进行选择，延长运行时间、增大吸力或减小噪声。

通过自动软件升级让您的智能吸尘机器人保持最新状态。



在 App Store 或 安卓 (Android) 应用商店下载最新的 Dyson Link 应用程序

打开应用程序，根据屏幕上的说明连接至您的智能吸尘机器人。



Apple 和 Apple 徽标是 Apple Inc. 在美国和其他国家/地区的注册商标。
App Store 是 Apple Inc. 在美国和其他国家/地区注册的服务标志。
Android 和 Android 徽标是 Google LLC. 的商标。
Android 机器人是在 Google 原创及共享成果的基础上再创作或修改而成，须遵照知识共享署名 3.0 许可所述条款付诸应用。

智能吸尘机器人的工作原理

实现最佳清洁效果的方法。



导航

专门设计的视觉系统，引导您的机器人在家中自主行动。

您的智能吸尘机器人可以环视 360°，定位其在您家中的位置。

它还使用红外线传感器来确定房间的大小，避开家具和楼梯等障碍。

提示：应当使用干燥的无绒布定期清洁镜头和红外线传感器，帮助您智能吸尘机器人看得更清晰。

清洁

您的机器人采用戴森专利技术组合，帮助你保持房屋洁净。

您的智能吸尘机器人使用全辐刷条来清洁房屋的边缘地带，并通过戴森数码马达选择功率级别，清洁所有地板类型。

提示：要帮助您的智能吸尘机器人保持自身清洁性能，可定期清洁滤网，并将碎屑从刷条和履带上清除。

个性化

使用Dyson Link应用程序来个性化您的机器人进行清洁的方式和时间。

给智能吸尘机器人设定计划，告诉它何时进行清洁。

在三个功率模式之间进行选择，并根据自己的房间状态调整机器人。

提示：保持更新你的应用程序，以便在新的功能和改进推出时，可以尽快使用。

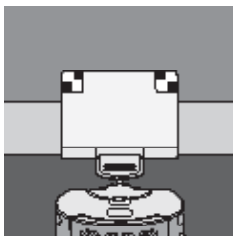
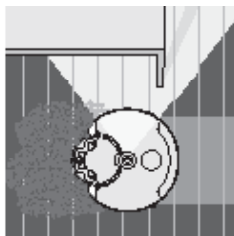

照明

LED 灯帮助您的智能吸尘器机器人在低光照度下进行清洁。

您的智能吸尘器机器人可感应低照度区域，并使用其 LED 灯环来选择性地照亮这些区域，帮助自己进行导航。

提示：通过定期用柔软、干燥的无绒布进行清洁，保持 LED 灯的洁净。

运行时间和充电

智能吸尘器机器人的运行时间和充电时间将始终是近似值。

您不必等到智能吸尘器机器人完全充满电即可让它开始清洁。

如果停靠在底座处，您的智能吸尘器机器人将自动充电。在清洁期间，您的智能吸尘器机器人不用充满电便可恢复工作，优化清洁花费的时间。

提示：有关清洁模式的更多信息，请参见“开始清洁”。

如需更多信息和支持：

在线方式：www.dyson.cn/supportcn

电子邮件：china.service@dyson.com

电话方式：4009 202 808

开始清洁

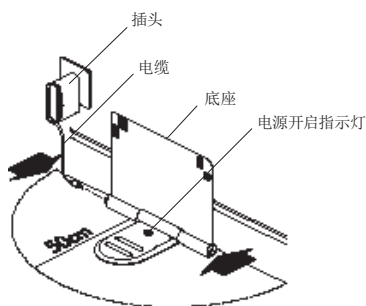

1

安装

完全打开底座至 90° ，并靠着墙放置。

将充电线插入底座任一側。

确保底座已通电，通电后底座上的蓝色灯将亮起。

将多余的电线绕在插头上。

确保底座的 50cm 半径范围内没有其他物体。

2

充电

将智能吸尘机器人放在底座上，透明集尘盒朝向墙壁。

电池灯指示您的智能吸尘机器人正在充电。

3

准备房间

移除智能吸尘机器人可能吸走的薄地毯和松动的物品。

整理鞋带或细电线等可能会缠在刷条上的障碍物。

清理可能会损坏智能吸尘机器人的泼洒液体或尖锐物品。

确保房间中任何台阶，或者高低落差处 10cm 范围内无袋子或鞋子等杂物。

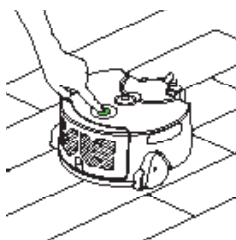
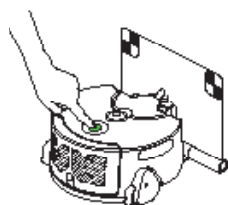

4

自动充电

按下按钮以清洁所有可到达的区域。

电池电量低时，智能吸尘机器人将返回底座重新充电。

一旦充好电，您的智能吸尘机器人将自动继续清洁。

单次充电

要清洁特定区域，请将机器人移开底座，在需要清洁区域启动您的智能吸尘机器人。

您的智能吸尘机器人将在单次充电的电力范围内清洁可到达之处。

电池电量低时，您的智能吸尘机器人将不会重新充电，而是返回其起始点并关闭。

提示：智能吸尘机器人不在充电底座上时无法通过Dyson Link App控制，请手动启动吸尘机器人。

如需更多信息和支持：

在线方式：www.dyson.cn/supportcn

电子邮件：china.service@dyson.com

电话方式：4009 202 808

保持智能吸尘机器人的性能

遵照一些定期、简单的维护步骤。

清洗并晾干滤网

每月至少用冷水清洗滤网一次。

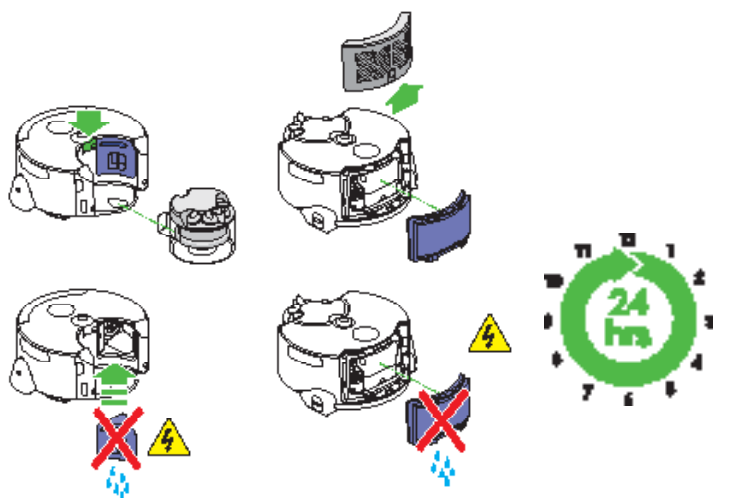

拆下前置滤网:

按下集尘盒释放按钮并拆下集尘盒后的滤网。

拆下后置滤网:

按下滤网盖的按钮并拆下。

从机器人中拉出滤网。

用冷水冲洗滤网，一直重复到水变清。

轻轻敲击以去除过多的水，并使其持续晾干24小时。

重装滤网前，请确保其已完全干燥。

重装前置滤网:

将滤网推回其所在位置，并重新装好透明集尘盒。

重装后置滤网:

将滤网推回其所在位置，并重新装好透明集尘盒。

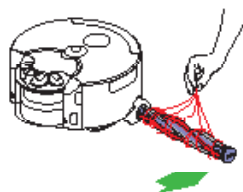

刷条维护

定期检查刷条。

使用硬币拆下刷条，并用手去除所有碎屑。

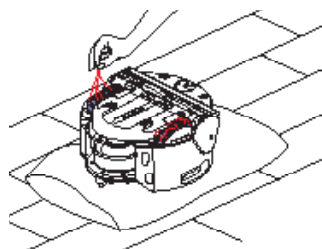

履带维护

定期检查履带。

将智能吸尘机器人翻转放置在柔软表面上，并用手去除一切碎屑。

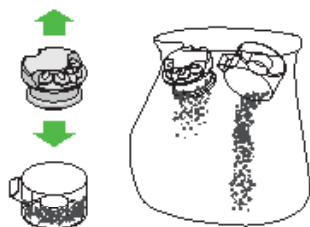

清空透明集尘筒

在每次清洁之前以及碎屑抵达 MAX 标志时进行该操作。按下集尘盒释放按钮。将整个集尘盒置于袋子中，将气旋集尘器从透明集尘盒中提起，并将内容物清空到袋子中。



一般清洁

定期检查您的红外线传感器、镜头和 LED 灯。

使用柔软、干燥的无绒布擦拭整个智能吸尘机器人，尤其是红外线传感器、镜头和 LED 灯。

保持智能吸尘机器人的性能

继续

软件升级

为了让您的智能吸尘机器人达到最佳性能，请升级至最新的软件。

通过 Dyson Link 应用程序自动升级

下载 Dyson Link 应用程序后，您将登记为自动升级。

智能吸尘机器人在可用软件升级时，将自动下载升级文件并在下次有机会时安装（机器人处于非工作状态 放在底座上并已连接至 Wi-Fi）。

通过 USB 手动升级

在戴森网站 www.dyson.cn/supportcn 上检查软件升级程序，并根据逐步说明操作。

如需更多信息和支持：

在线方式：www.dyson.cn/supportcn

电子邮件：china.service@dyson.com

电话方式：4009 202 808

了解智能吸尘机器人的指示灯

清洁期间

清洁/暂停按钮

按下按钮开始清洁或暂停智能吸尘机器人。要关闭电源，请按住按钮，直至灯熄灭。

电池电量



返回至底座

表示您的智能吸尘机器人正返回至其底座以进行充电。

清洁状态环
指示智能吸尘机器人的状态。

Wi-Fi 连接状态

获取 Dyson Link 应用程序了解更多信息。

您的智能吸尘机器人需要您的关注

一旦您完成了智能吸尘机器人维护，可按下按钮恢复清洁。遵照“保持智能吸尘机器人的性能”中的说明。

空气通道受阻

检查智能吸尘机器人空气通道中的阻塞物。清洁智能吸尘机器人的滤网。

履带或智能吸尘机器人阻塞

检查粘附在智能吸尘机器人履带上的碎屑。把机器人从障碍物上移除并移至继续进行清洁。

清洁停止

您的智能吸尘机器人无法完成其清洁工作。将智能吸尘机器人放回底座，再开始下次清洁。

条阻塞

查粘附在智能吸尘机器人刷条上的碎屑。



致电戴森帮助热线

您的智能吸尘机器人可能需要戴森的帮助。



软件升级

您的智能吸尘机器人正在升级其软件。等到灯熄灭，然后再如常开始清洁。

Dyson Customer Care

If you have a question about your Dyson appliance, call the Dyson Helpline with your serial number and details of where and when you bought the appliance.

Call: 4009 202 808 between

Monday to Sunday 9 am- 6 pm

Email: china.service@dyson.com

Chat: www.dyson.cn/supportcn

戴森客户服务

关于戴森产品,如果您有任何问题,请拨打戴森客户帮助热线,提供给我们产品序列号和购买产品的详细时间和地点。

致电: 4009 202 808 周一至周日: 上午9点至下午6点

电子邮件: china.service@dyson.com

聊天: www.dyson.cn/supportcn